

6" - 24" PIPE BENDING MACHINE



- With the hydraulic pistons placed under the machine
Shaft breaks removed
Wear of shaft slots reduced
Less energy stabil bending
Lightweight ergonomic machines
Safe working area for operator
- PTO available for mandrel feeding
- Equipped with winch for pipe handling
- Polyurethane lined bending sets available
- Wide bending range
- CE Certification





Bending Sets

Denksan bending sets are

- Manufactured with high quality steel, welded and reinforced in high stress areas for maximum strength and resistance.
- The internal surface is finished with tooling machines to guarantee the required accuracy.
- The internal can also be proposed with polyurethane lining upon request.
- Bending sets are compatible with bending machines by other manufacturer.

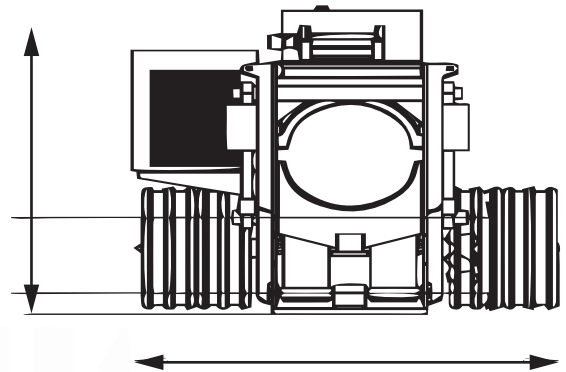
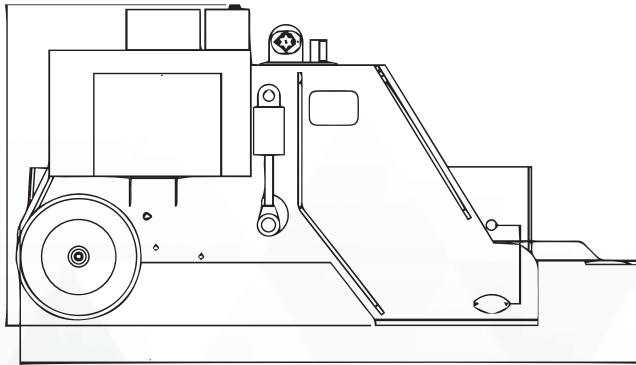

DIMENSIONS

Length	4174 mm
Width	2143 mm
Height	2144 mm
Weight	7000 kg

INTERNAL PNEUMATIC PIPE LINE-UP



Our MZN series pneumatic internal pipe line-up clamps (IPLC) are used to align two pipes joints from inside the pipe for welding. They are available from 6" to 60" as standard.

Our IPLCs are equipped with sturdy Ingersoll Rand air motor for harsh working conditions. Large air tank provides air both to drive the clamp back and forth and to operate the clamping mechanism. Clamping height of the shoes can be adjusted to suit various wall thickness by changing shims.

High Grade Aluminum Body for Clamping Shoes

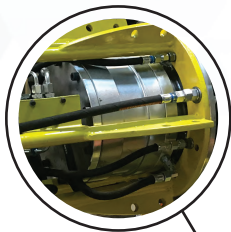

High Quality Steel Shoes



Lifting Eye



Polyurethane Lined Drive Wheel

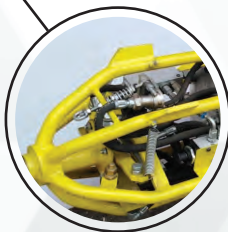
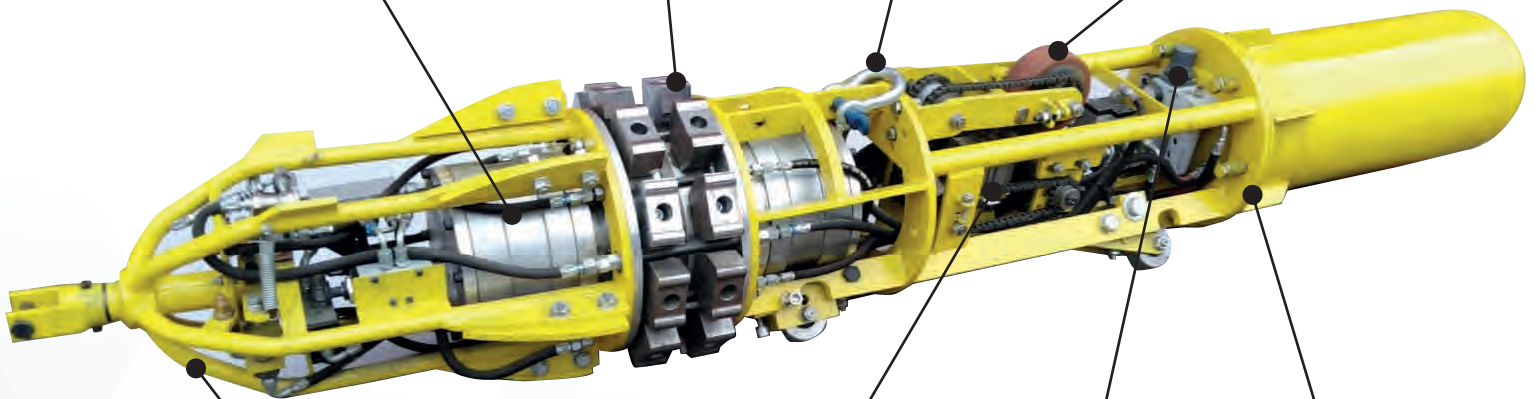

Sturdy Nose Cone



Air Motor

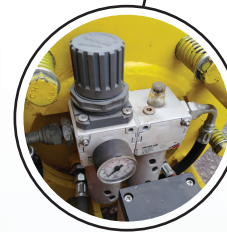

Air Mist Lubrication

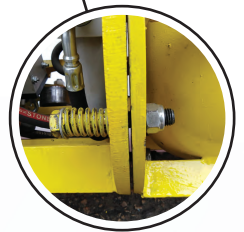

Flexible Mounted Steel Air Tank

Main Features:

- Durable frame and nose cone
- High grade aluminum body for clamping shoes
- Italian pneumatic valves and air mist lubrication
- Working Pressure: 12 bar (min. 8 bar)
- A brass spacer ring is placed between aluminum clamp shoe housings to avoid sticking of welding spatter
- Clamp shoes equipped with steel rollers (optional)
- Polyurethane lined drive wheel
- Flexible Mounted Steel Air Tank
- Remote operation by reach rod
- 20 degree climbing capability
- Powered line travel from 12" and up
- CE Certification

Model No.	Nominal Pipe Size		Length	Width	Height	Drive
	inches	mm				
IPLC 6	6	168	1,041	140	140	
IPLC 8	8	219	1,194	190	229	
IPLC 10	10	273	1,575	254	292	
IPLC 12-14	12-14	324-356	2,286	305	343	Air Power
IPLC 16-18	16-18	406-457	2,921	406	445	Air Power
IPLC 20-22	20-22	508-559	2,921	470	508	Air Power
IPLC 24-26	24-26	610-660	2,794	610	648	Air Power
IPLC 28-32	28-32	711-813	3,073	711	749	Air Power
IPLC 34-36	34-36	864-914	3,251	864	902	Air Power
IPLC 36-38	36-38	914-965	3,251	914	953	Air Power
IPLC 40-42	40-42	1,016-1,067	3,531	1,016	1,054	Air Power
IPLC 46-48	46-48	1,168-1,219	3,658	1,143	1,181	Air Power
IPLC 52-54	52-54	1,321-1,372	4,572	1,321	1,359	Air Power
IPLC 54-56	54-56	1,372-1,422	4,699	1,372	1,410	Air Power
IPLC 60	60	1,524	4,826	1,473	1,524	Air Power

HYDRAULIC WEDGE MANDRELS

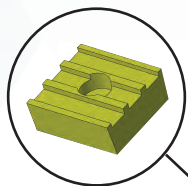
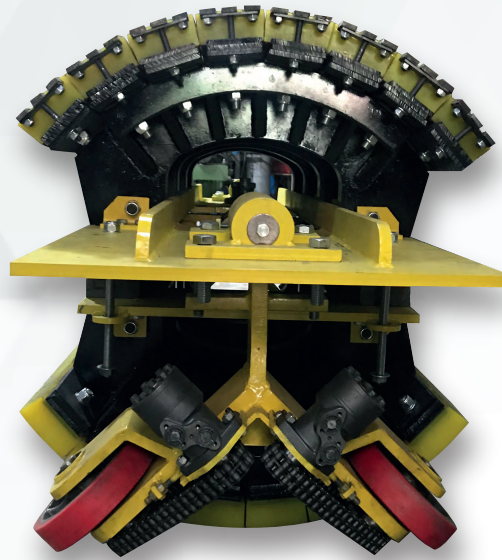

Shoes are made up of high grade 90 shore polyurethane.

The support bars are made up of spring steel.

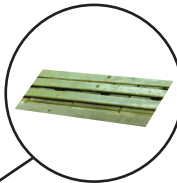

The travel wheels are pivotally mounted to provide self-leveling of the mandrel in the pipe.

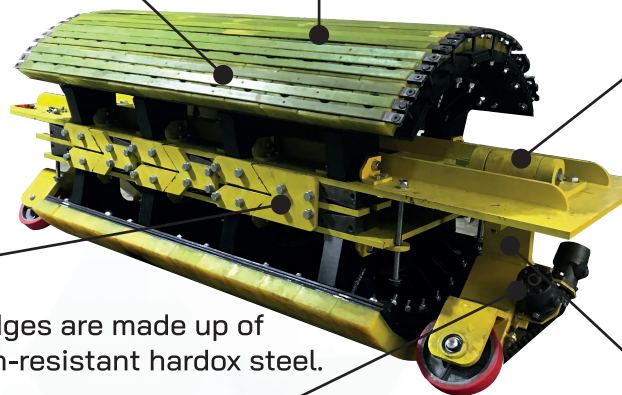
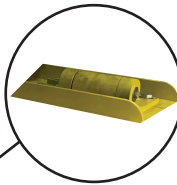

The wedges are made up of abrasion-resistant hardox steel.

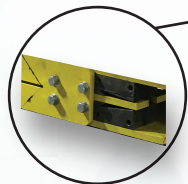

Travel wheels raise from the pipe wall when the mandrel is expanded.



Drive system



- Up to 14": manual
- 16" to 24": by single hydraulic motor and 2 driving wheels. Drive system operates by roller chain sprocket mechanism.
- 26" to 60": by twin hydraulic motor and 2 driving wheels. Drive system operates by roller chain sprocket mechanism.

Model No	Pipe Size		Lenght		Width		Height		Cube		Weight	
	inches	mm	inches	mm	inches	mm	inches	mm	ft 3	m3	lb	kg
HWM 8	8	203	52,8	1340	6,3	160	4,7	120	0,91	0,03	187	85
HWM 10-12	10	254	57,5	1460	7,1	180	8,1	207	1,92	0,05	209	95
	12	305	57,5	1460	7,1	180	8,1	207	1,92	0,05	286	130
HWM 16-18	16	406	70,5	1790	10,2	260	13,4	340	5,59	0,16	660	300
	18	457	70,5	1790	10,2	260	13,4	340	5,59	0,16	660	300
HWM 20-24	20	508	70,5	1790	13,4	340	17,3	440	9,46	0,27	1430	650
	22	558	70,5	1790	13,4	340	17,3	440	9,46	0,27	1430	650
	24	588	70,5	1790	13,4	340	19,3	490	10,53	0,30	1430	650
HWM 26-30	26	660	86,2	2190	16,5	420	19,3	490	15,91	0,45	2200	1000
	28	711	86,2	2190	16,5	420	24,8	630	20,46	0,58	2200	1000
	30	762	86,2	2190	16,5	420	24,8	630	20,46	0,58	2420	1100
HWM 32-36	32	813	102,4	2600	29,3	744	26,8	680	46,45	1,32	2640	1200
	34	864	102,4	2600	29,3	744	26,8	680	46,45	1,32	2640	1200
	36	914	102,4	2600	29,3	744	27,2	690	47,13	1,33	3300	1500
HWM 40-42	40	1016	102,4	2600	35,9	912	27,8	706	59,11	1,67	3850	1750
	42	1067	102,4	2600	35,9	912	27,8	706	59,11	1,67	3850	1750
HWM 46-48	46	1168	108,3	2751	38,5	978	38,6	980	93,10	2,64	10560	4800
	48	1219	108,3	2751	38,5	978	38,6	980	93,10	2,64	10560	4800
HWM 52-54	52	1321	122,0	3100	43,3	1100	46,0	1168	140,64	3,98	11484	5220
	54	1372	122,0	3100	43,3	1100	47,2	1200	144,49	4,09	11484	5220
HWM 56	56	1422	143,7	3650	53,3	1354	50,0	1270	221,62	6,28	13200	6000
HWM 60	60	1524	145,7	3700	55,1	1400	53,9	1370	250,58	7,10	13420	6100

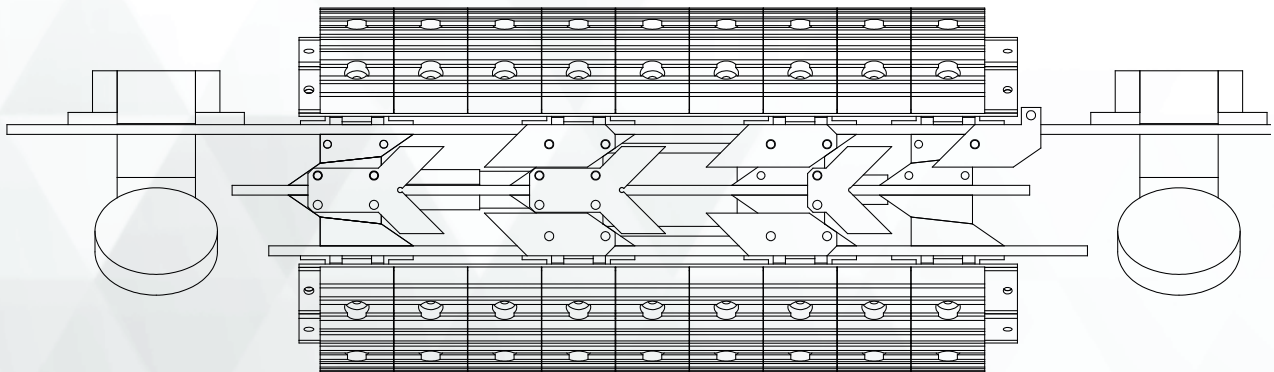

PIPE LIFTING CHOKER BELT



- Choker belts are used to roll or pull pipe or hold the pipe tightly in welding
- Secure extreme bends-all without damage
- Fastest tool available for positioning and handling pipe
- Available up to 60" pipe diameter and up to 14,5 ton (28 ton/double choker belt) capacity.

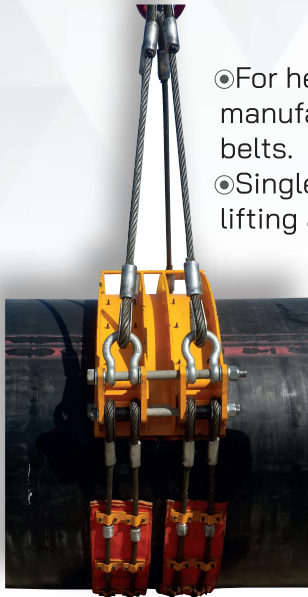

- For heavy duty work, we manufacture double choker belts.
- Single point lift for easy lifting and positioning.

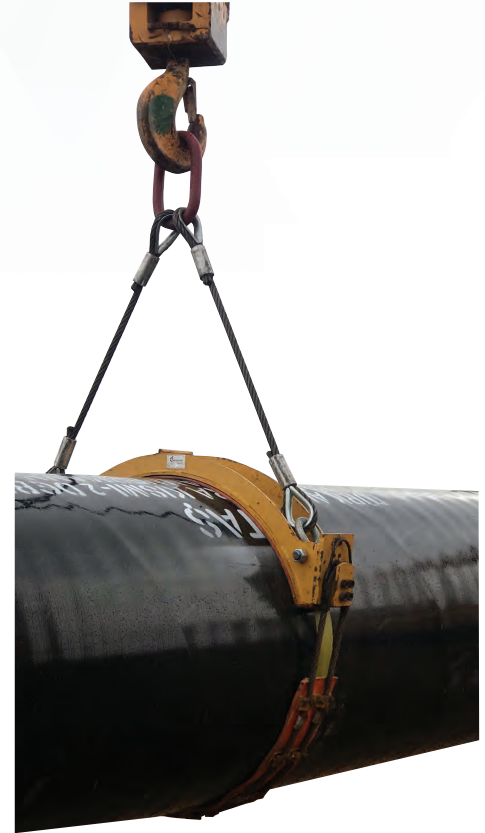

Model	Max. Pipe Diameter		Belt Width		Approx Weight		Rated Capacity	
	inches	mm	inches	mm	lbs.	kg	lbs.	kg
DCB-10"	10"	254	9,5"	240	50	23	8,818	4,000
DCB-12"	12"	305	9,5"	240	93	42	8,818	4,000
DCB-14"	14"	356	9,5"	240	109	49	8,818	4,000
DCB-16"	16"	406	9,5"	240	115	52	8,818	4,000
DCB-18"	18"	457	9,5"	240	120	54	8,818	4,000
DCB-20"	20"	508	9,5"	240	125	57	8,818	4,000
DCB-22"	24"	607	9,5"	240	133	60	17,636	8,000
DCB-26"	26"	660	9,5"	240	137	62	17,636	8,000
DCB-28"	28"	711	9,5"	240	140	64	17,636	8,000
DCB-30"	30"	762	9,5"	240	142	64	17,636	8,000
DCB-36"	36"	660	9,5"	240	160	73	17,636	8,000
DCB-40"	40"	1016	9,5"	240	190	86	22,046	10,000
DCB-42"	42"	1067	9,5"	240	200	91	22,046	10,000
DCB-48"	48"	1219	9,5"	240	210	95	28,660	13,000
DCB-56"	56"	1422	9,5"	240	225	102	28,660	13,000
DCB-60"	60"	1524	9,5"	240	235	107	31,967	14,500

- 5 to 1 design factor standard
- 7 to 1 design factors available upon request
- Higher capacities available on special request

Designed to meet or exceed: ASME B30.9 Slings, B30.20 Below-the-Hook Lifting Devices
AWS D14.1 Welding Procedures

LOWERING IN BELTS

- High quality and durable nylon webbing for durability and strength
- Alloy steel for lightweight, durable and long lasting products
- Two coats and primed paint
- Custom belts available for pipe any diameters
- Lowering-in belt and head iron sold separately

Model	Max. Pipe Diameter		Belt Width		Belt Length		Rated Capacity	
	inches	mm	inches	mm	ft. - in	m	lbs.	kg
D-PLB 12	12"	254	9,5"	240	4'-9"	1.45	55,115	25,000
D-PLB 18	18"	305	9,5"	240	7'-0"	2.13	88,184	40,000
D-PLB 20	20"	356	9,5"	240	7'-6"	2.29	88,184	40,000
D-PLB 24	24"	406	9,5"	240	8'-6"	2.59	110,231	50,000
D-PLB 30	30"	457	9,5"	240	10'-0"	3.05	132,277	60,000
D-PLB 36	36"	508	9,5"	240	11'-6"	3.51	154,323	70,000
D-PLB 42	42"	607	9,5"	240	13'-6"	4.11	154,323	70,000
D-PLB 48	48"	660	9,5"	240	15'-0"	4.57	154,323	70,000
D-PLB 42	42"	711	9,5"	240	13'-6"	4.11	187,392	85,000
D-PLB 48	48"	762	9,5"	240	15'-0"	4.57	187,392	85,000
D-PLB 48	48"	660	9,5"	240	15'-0"	4.57	209,439	95,000
D-PLB 56	56"	1016	9,5"	240	17'-0"	5.18	209,439	95,000
D-PLB 56	56"	1067	9,5"	240	17'-0"	5.18	242,508	110,000
D-PLB 60	60"	1219	9,5"	240	18'-0"	5.49	242,508	110,000

- 6 to 1 design factor standard
- 7 to 1 design factors available upon request
- Pipe sizes and lengths not listed available on special request

Designed to meet or exceed: ASME B30.9 Slings, AWS D14.1 Welding Procedures

HOOKS IRON HEAD

- Used to suspend lowering-in belts
- Alloy steel bail for greater strength with less weight
- Two coats and primed paint
- Aluminium Data Plate
- Easy release hooks on one side



* Different designs for high tonnages.

ROLLER CRADLES

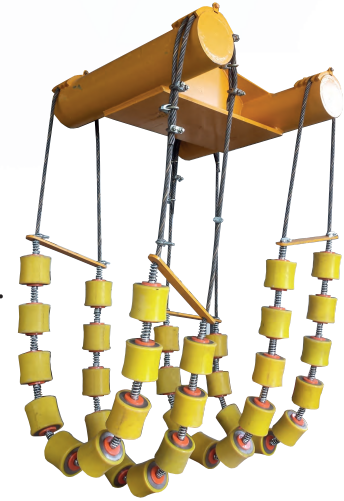

- Roller cradles are manufactured from cast iron coated with poly urethane.
- Denksan roller cradles are used in line travel operations.
- The urethane rollers ride easily over weld seams and do not hang up.
- Antifriction bearing slower Rolling resistance.
- Production Range: 6"-12" / 12"-24" / 24"-36" / 36"-48" / 48"-60"

EXTERNAL PIPE CLAMPS

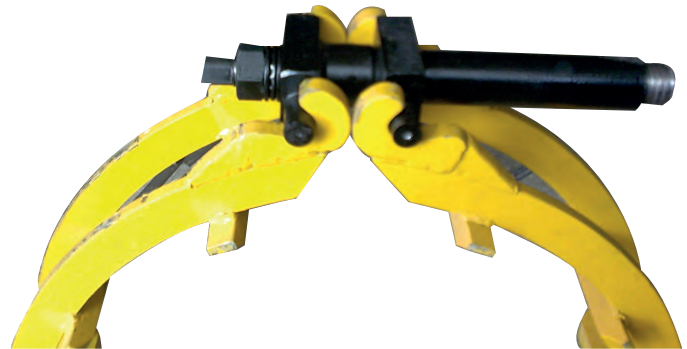

Hinged segments enhance flexibility and handling of large diameter pipes. Web-like double ring design consummates alignment and provides full accessibility for 360 degree welding.

For Tightening:

4"-16" manual , 18"-36" Ratchet Drive - hydraulic Jacks
36"-120" Ratchet Drive - hydraulic Jacks (High Tonnage)



PIPELINE PIGS FOR FILLING, CLEANING AND DRYING

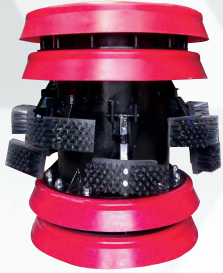

One-Way Steel Body
Conical Cup Filling and
Cleaning Pigs



Two-Way Steel Body
Flat Disc Filling and
Cleaning Pigs



Polyurethane Body
Cleaning and Filling Pigs



Foam Drying and Cleaning Pigs

PIPE BEVELING AND CUTTING EQUIPMENT



BAND TYPE CUTTING AND BEVELING MACHINE

Cuts the pipes within the range of 6"-60", forming welding bent. Adjustable cap allows welding at different angles. It is remotely controlled with a 3m cable rope.

PIPE CUTTING TORCH AND NOZZLES



Torch



Angle Head



Cutting Nozzles